

FIELD AND SUSTAINMENT MAINTENANCE  
REPAIR PARTS AND SPECIAL TOOLS LIST

TRUCK, CARGO: 2-1/2-TON, 6X6, M44A2 SERIES TRUCKS (MULTIFUEL)

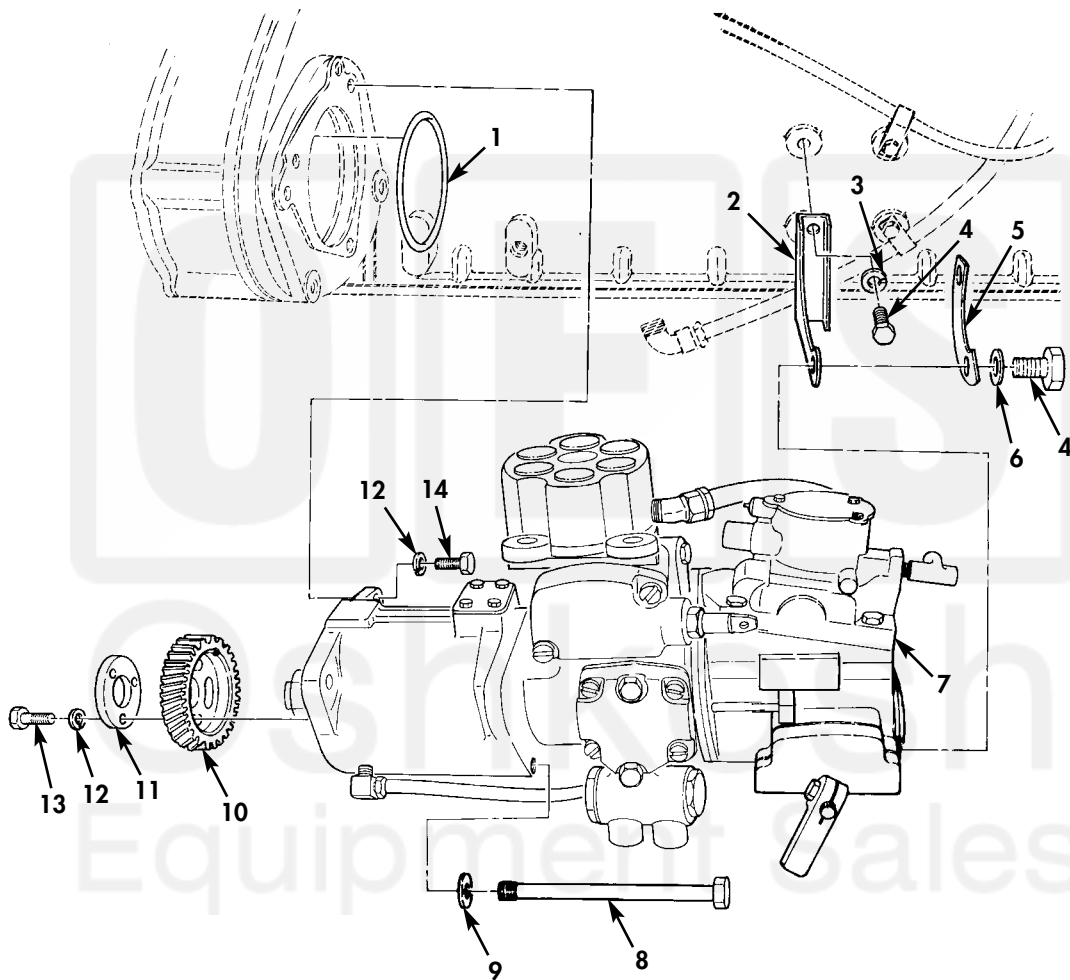

Figure 18. Fuel Injector Pump and Related Parts.

(1) ITEM NO	(2) SMR CODE	(3) NSN	(4) CAGEC	(5) PART NUMBER	(6) DESCRIPTION AND USABLE ON CODE (UOC)	(7) QTY
GROUP 0302 FUEL PUMPS						
FIG. 18 FUEL INJECTOR PUMP AND RELATED PARTS						
1	PAFZZ	5331-00-582-1560	96906	MS28775-235	O-RING.....	1
2	PFFZZ	5340-00-178-1362	19207	10912553	BRACKET,ANGLE.....	1
3	PAFZZ	5310-00-959-4679	96906	MS35340-45	WASHER,LOCK.....	2
4	PAFZZ	5306-00-225-8496	96906	MS90725-31	BOLT,MACHINE.....	4
5	PAFZZ	5340-00-101-5600	19207	11610207	LOCKING PLATE,NUT A.....	1
6	PAFZZ	5310-00-194-0636	96906	MS9320-11	WASHER,FLAT.....	2
7	PAFHH	2910-00-116-8241	01843	KT9073-3	PUMP,FUEL,METERING SEE TM9-2910-226-34P FOR REPAIR PARTS...	1
8	PAFZZ	5306-00-728-9959	19207	10935554	BOLT,SELF-LOCKING.....	1
9	PAFZZ	5310-00-080-6004	96906	MS27183-14	WASHER,FLAT.....	1
10	PAFZZ	3020-00-313-8543	19207	10935218	GEAR,HELICAL.....	1
11	PAFZZ	5365-00-860-0571	19207	10889762	SPACER,BLOCK.....	1
12	PAFZZ	5310-00-959-4675	96906	MS35340-46	WASHER,LOCK.....	10
13	PAFZZ	5305-00-269-3237	80204	B1821BH038F113N	SCREW,CAP,HEXAGON H.....	3
14	PAFZZ	5305-00-543-2419	80204	B1821BH038C113N	SCREW,CAP,HEXAGON H.....	2

END OF FIGURE

